



## Hendon Wood Lane, Mill Hill, NW7

**£1,560,000**

Located on the highly sought-after Hendon Wood Lane is this beautifully presented four-bedroom detached family home.

Offering 2,498 sq ft of flexible living space, the ground floor features a spacious entrance hall leading to a dedicated office, an additional bedroom with en-suite bathroom, and a stunning open-plan kitchen, dining, and living area perfect for modern family living and entertaining. This impressive space opens directly onto a beautifully maintained rear garden. Further benefits on this level include ample storage and a guest W/C.

On the first floor, the principal bedroom enjoys its own en-suite bathroom and a private terrace overlooking the garden. There are also two further well-proportioned bedrooms and a contemporary family bathroom.

Additional advantages include off-street parking for multiple vehicles, proximity to excellent local schools, convenient transport links, and the shops, cafés, and amenities of Mill Hill Broadway.

Sole Agent.

### Viewing

Please contact our Mill Hill Office on 02089590011 if you wish to arrange a viewing appointment for this property or require further information.

- 2498 Sq Ft - 4 bedroom detached house
- Spacious reception room
- Large bright dining room
- Conservatory overlooking the garden
- Modern fitted kitchen
- Separate utility and study
- Main bedroom with terrace
- Garden house can be used as a gym/office
- Off-Street parking



4



3



3



D

# Floor Plan

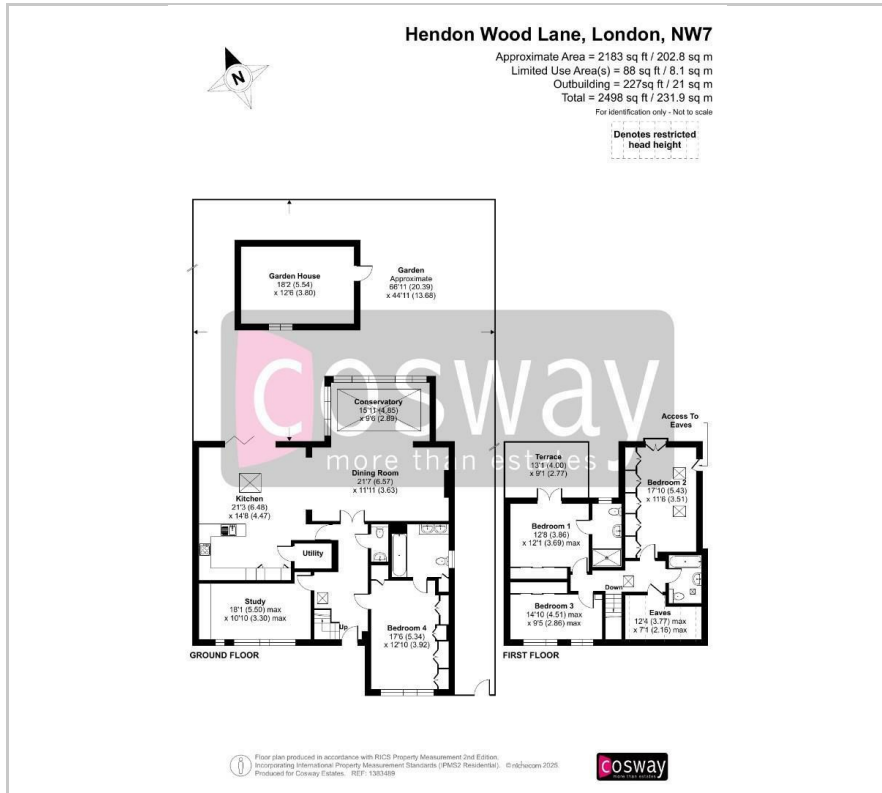

# Area Map



# Energy Efficiency Graph

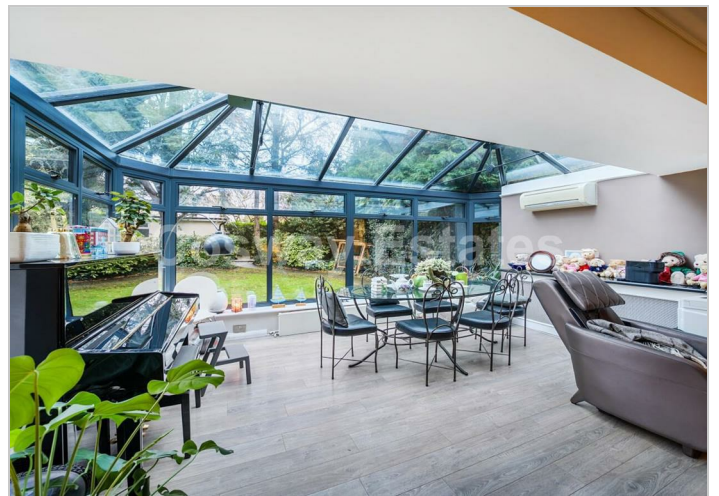
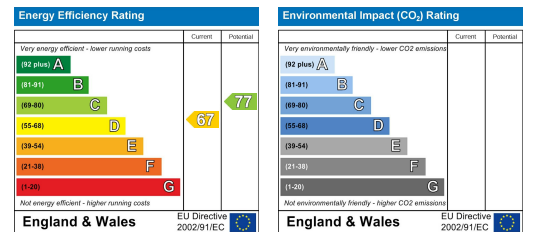

These particulars, whilst believed to be accurate are set out as a general outline only for guidance and do not constitute any part of an offer or contract. Intending purchasers should not rely on them as statements of representation of fact, but must satisfy themselves by inspection or otherwise as to their accuracy. No person in this firm's employment has the authority to make or give any representation or warranty in respect of the property.